

PREMIUM BOOTH

6M X 3M Booth

六米乘三米攤位攤位

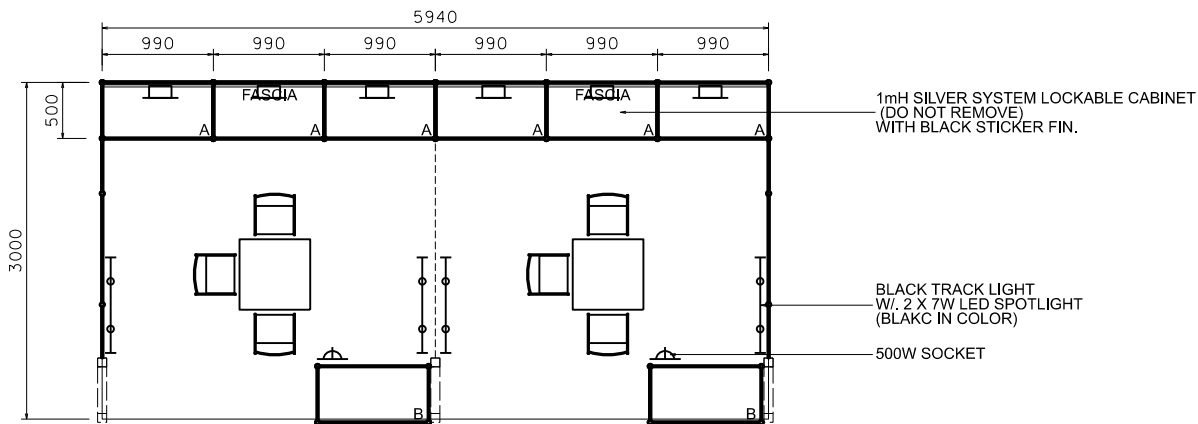

PLAN

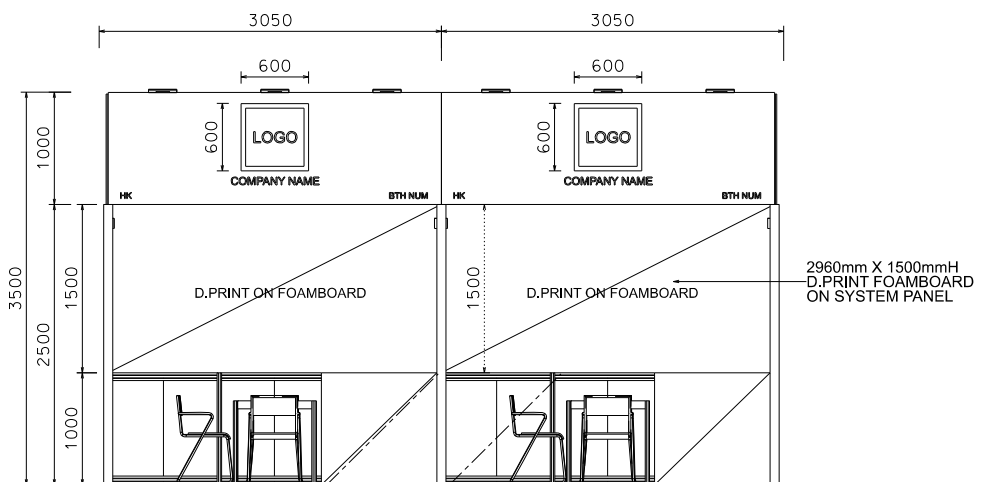

ELEVATION

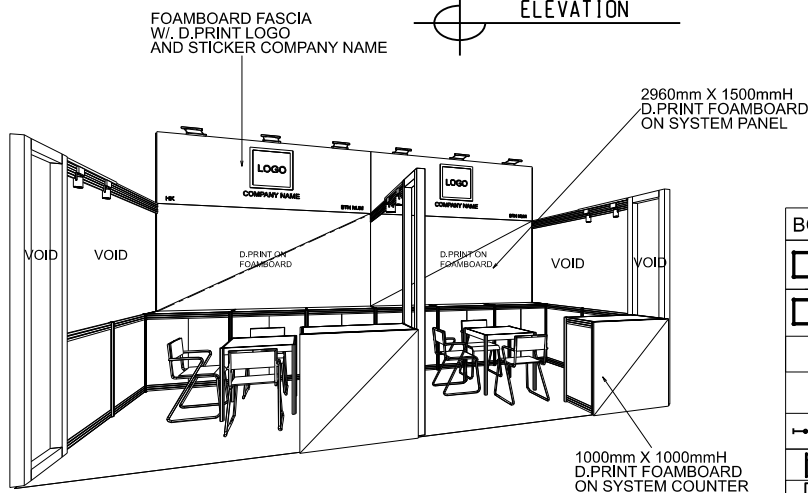

PERSPECTIVE

BOOTH SPECIFICATIONS		QTY.
	1000W x 500D x 1000H LOCKABLE CABINET (DO NOT REMOVE), SILVER SYSTEM W/ BLACK STICKER FIN.	6
	1000W x 500D x 1000H LOCKABLE CABINET, SILVER SYSTEM W/ BLACK STICKER FIN., FRONTAGE 1000mm X 1000mmH D.PRINT FOAMBOARD	2
	2960mm X 1500mmH D.PRINT FOAMBOARD ON SYSTEM PANEL	2
	FOAMBOARD FASCIA W/ D.PRINT LOGO AND STICKER COMPANY NAME	2
	BLACK TRACK LIGHT W/ 2 X 7W LED SPOTLIGHT (WHITE LIGHT)	4
	BLACK LEATHER CHAIR	6
	700 X 700 X 750mmH SQUARE MEETING TABLE	2
	500W SQUARE PIN POWER SOCKET	2
	24W LED GILBERT LAMP	6
	RUBBISH BIN & CARPET (18sqm.)	

PREMIUM BOOTH

6M X 3M Left Corner Booth

六米乘三米攤位左邊角位攤位

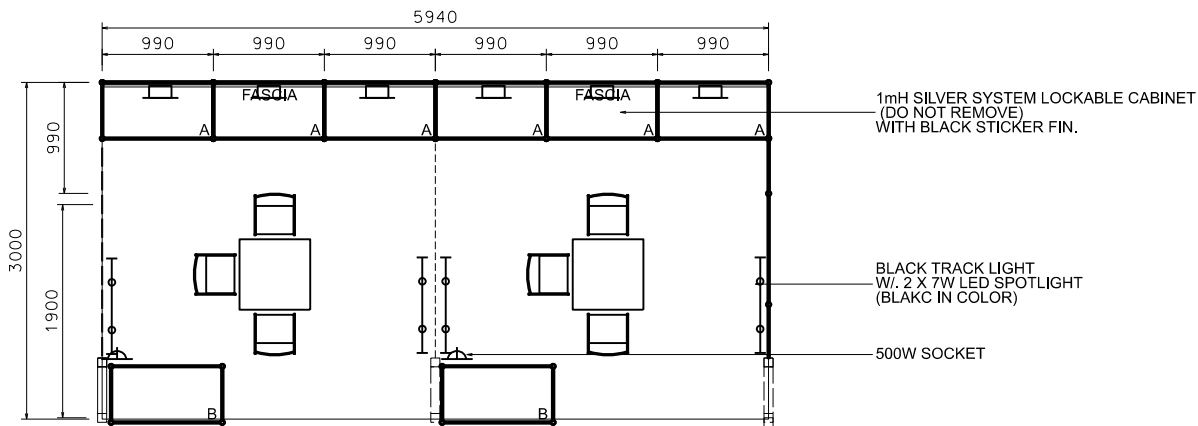

PLAN

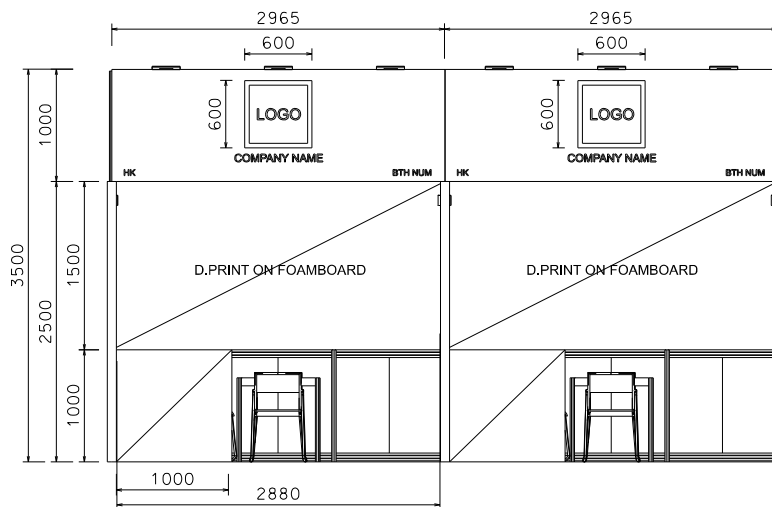

ELEVATION

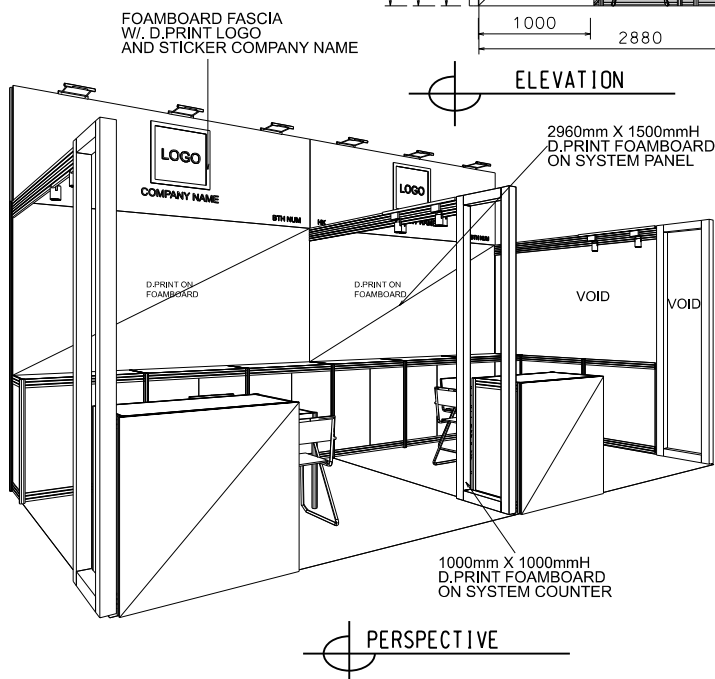

PERSPECTIVE

BOOTH SPECIFICATIONS	QTY.
1000W x 500D x 1000H LOCKABLE CABINET (DO NOT REMOVE), SILVER SYSTEM W/ BLACK STICKER FIN.	6
1000W x 500D x 1000H LOCKABLE CABINET, SILVER SYSTEM W/ BLACK STICKER FIN., FRONTAGE 1000mm X 1000mmH D.PRINT FOAMBOARD	2
2960mm X 1500mmH D.PRINT FOAMBOARD ON SYSTEM PANEL	2
FOAMBOARD FASCIA W/ D.PRINT LOGO AND STICKER COMPANY NAME	2
BLACK TRACK LIGHT W/ 2 X 7W LED SPOTLIGHT (WHITE LIGHT)	4
BLACK LEATHER CHAIR	6
700 X 700 X 750mmH SQUARE MEETING TABLE	2
500W SQUARE PIN POWER SOCKET	2
24W LED GILBERT LAMP	6
RUBBISH BIN & CARPET (18sqm.)	

*The Hong Kong Trade Development Council reserves the right to change the configuration if necessary.

*如有需要，香港貿易發展局有權更改攤位結構。

PREMIUM BOOTH

6M X 3M Right Corner Booth

六米乘三米攤位右邊角位攤位

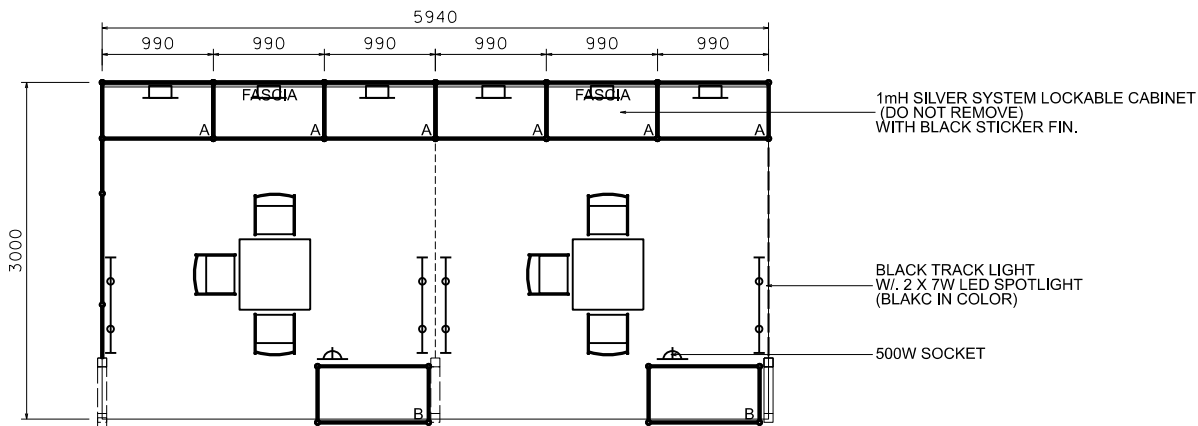

PLAN

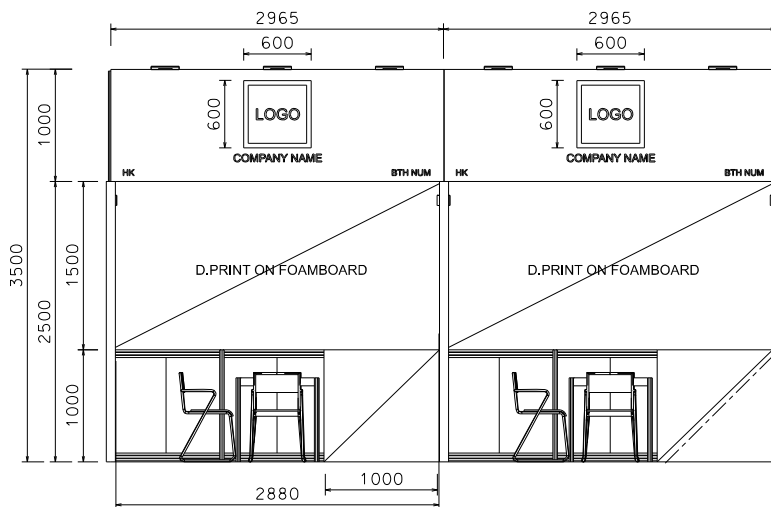

ELEVATION

FOAMBOARD FASCIA W/ D.PRINT LOGO AND STICKER COMPANY NAME

2960mm X 1500mmH D.PRINT FOAMBOARD ON SYSTEM PANEL

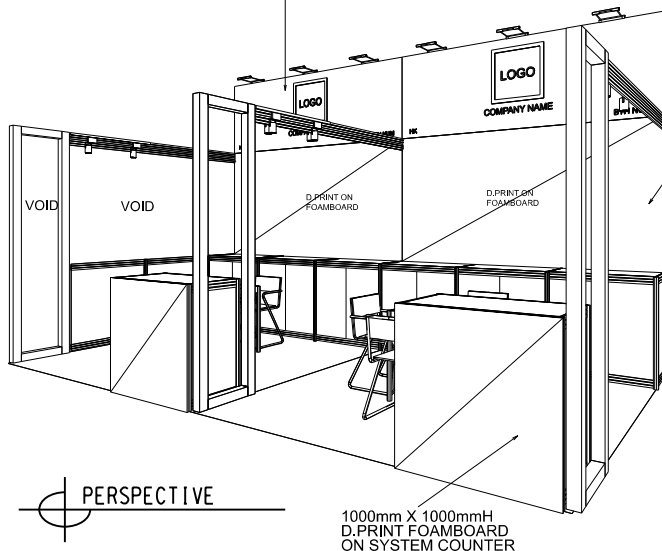

BOOTH SPECIFICATIONS	QTY.
1000W x 500D x 1000H LOCKABLE CABINET (DO NOT REMOVE), SILVER SYSTEM W/ BLACK STICKER FIN.	6
1000W x 500D x 1000H LOCKABLE CABINET, SILVER SYSTEM W/ BLACK STICKER FIN., FRONTAGE 1000mm X 1000mmH D.PRINT FOAMBOARD	2
2960mm X 1500mmH D.PRINT FOAMBOARD ON SYSTEM PANEL	2
FOAMBOARD FASCIA W/ D.PRINT LOGO AND STICKER COMPANY NAME	2
BLACK TRACK LIGHT W/ 2 X 7W LED SPOTLIGHT (WHITE LIGHT)	4
BLACK LEATHER CHAIR	6
700 X 700 X 750mmH SQUARE MEETING TABLE	2
500W SQUARE PIN POWER SOCKET	2
24W LED GILBERT LAMP	6
RUBBISH BIN & CARPET (18sqm.)	

*The Hong Kong Trade Development Council reserves the right to change the configuration if necessary.

*如有需要，香港貿易發展局有權更改攤位結構。

PREMIUM BOOTH

6M X 3M Peninsula Booth

六米乘三米半島攤位

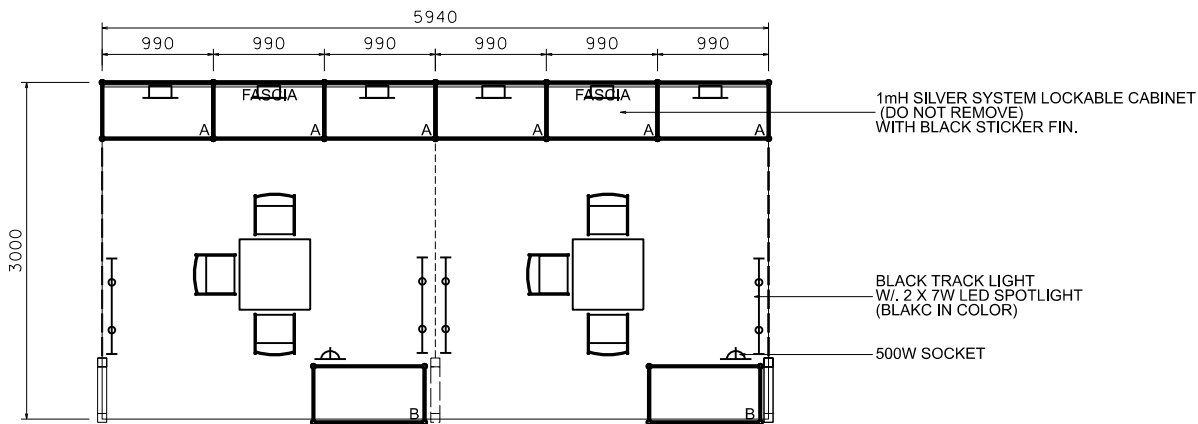

PLAN

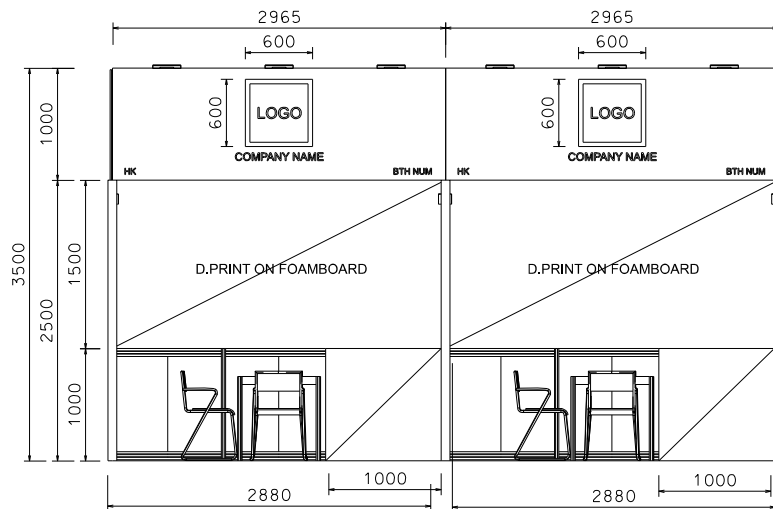

ELEVATION

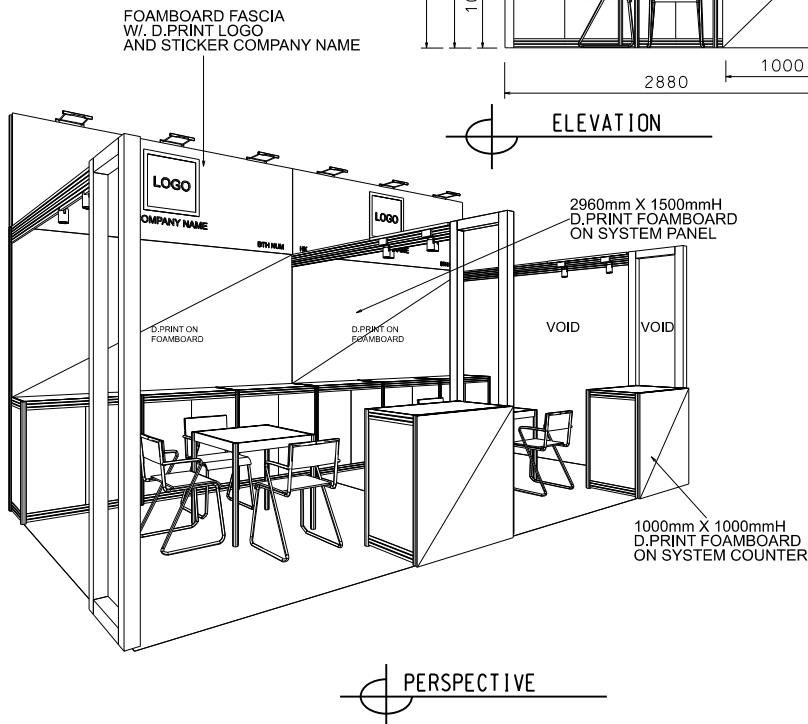

PERSPECTIVE

BOOTH SPECIFICATIONS		QTY.
	1000W x 500D x 1000H LOCKABLE CABINET (DO NOT REMOVE), SILVER SYSTEM W/ BLACK STICKER FIN.	6
	1000W x 500D x 1000H LOCKABLE CABINET, SILVER SYSTEM W/ BLACK STICKER FIN., FRONTAGE 1000mm X 1000mmH D.PRINT FOAMBOARD	2
	2960mm X 1500mmH D.PRINT FOAMBOARD ON SYSTEM PANEL	2
	FOAMBOARD FASCIA W/ D.PRINT LOGO AND STICKER COMPANY NAME	2
	BLACK TRACK LIGHT W/ 2 X 7W LED SPOTLIGHT (WHITE LIGHT)	4
	BLACK LEATHER CHAIR	6
	700 X 700 X 750mmH SQUARE MEETING TABLE	2
	500W SQUARE PIN POWER SOCKET	2
	24W LED GILBERT LAMP	6
	RUBBISH BIN & CARPET (18sqm.)	